



## 4 Myrtle Cottages Long Garden Walk Surrey

2  1 

\*\*\* Freshly refurbished \*\*\* A character end of terrace home, in a tucked away location, within the heart of Farnham's elegant Georgian town centre. The house has undergone refurbishment in 2021 and more recently in 2024 to include a new kitchen and bathroom as well as redecoration. The property further benefits from a courtyard style garden to the front. A character end of terrace home, in a tucked away location, within the heart of Farnham's elegant Georgian town centre. Resident permits cost £84 for the first permit issued to a household, £104 for the second permit issued to the same household and £134 for a third and subsequent permits. Material Information - Ultrafast broadband available and good mobile signal likely with all providers outside.

**Price** : Price Guide £1,295

**View** : <https://www.keatsfearn.co.uk/to-let/-/farnham/surrey/residential/end-of-terrace/7847695>



**James Fearn**  
01252 718018

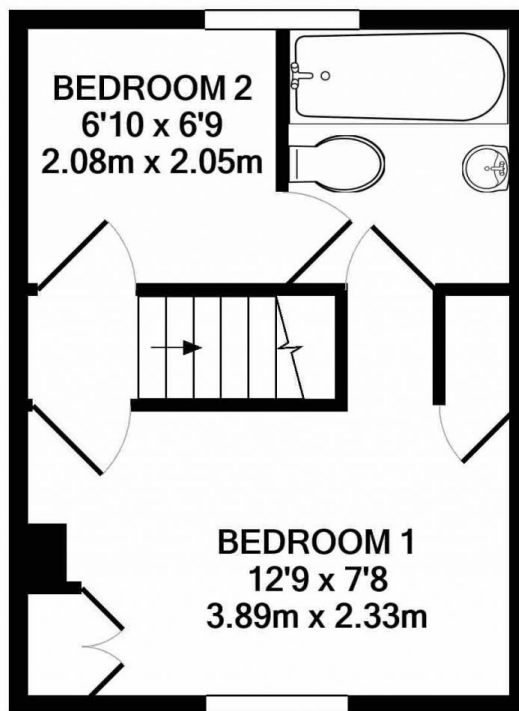
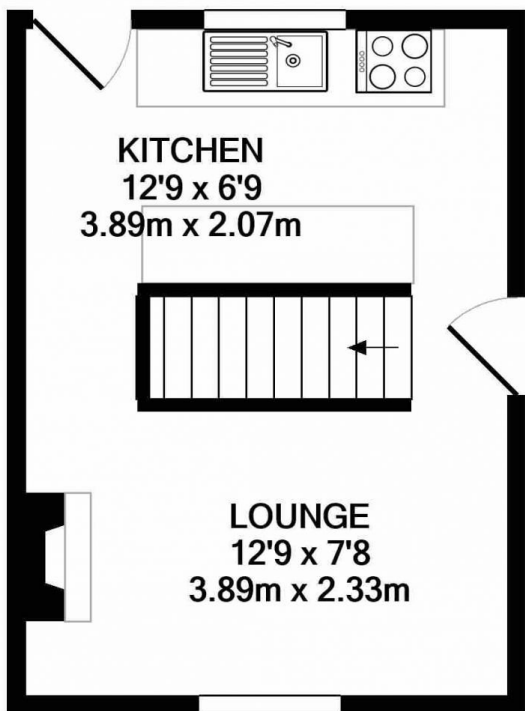

GROUND FLOOR  
 APPROX. FLOOR  
 AREA 223 SQ.FT.  
 (20.7 SQ.M.)

1ST FLOOR  
 APPROX. FLOOR  
 AREA 221 SQ.FT.  
 (20.5 SQ.M.)

TOTAL APPROX. FLOOR AREA 444 SQ.FT. (41.3 SQ.M.)

Whilst every attempt has been made to ensure the accuracy of the floor plan contained here, measurements of doors, windows, rooms and any other items are approximate and no responsibility is taken for any error, omission, or mis-statement. This plan is for illustrative purposes only and should be used as such by any prospective purchaser. The services, systems and appliances shown have not been tested and no guarantee as to their operability or efficiency can be given

Made with Metropix ©2020